

# G02772

# Goldblatt®

SINCE 1885

**4.6 A**

**7 in.  
180 mm**

## ***Tile Wet Saw***

Español página 18

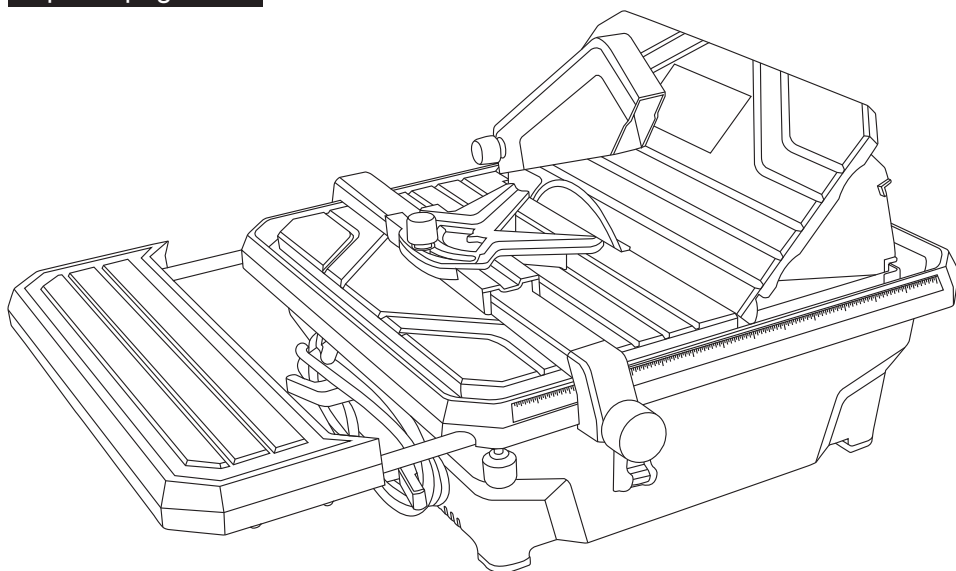

### ATTACH YOUR RECEIPT HERE

Serial Number \_\_\_\_\_

Purchase Date \_\_\_\_\_

MNL\_G02772\_V02\_20170328



Questions, problems, missing parts? Before returning to your retailer, call our customer service department at 1-877-876-7562, 8 a.m. - 5 p.m., CST, Monday - Friday.

## TABLE OF CONTENTS

---

Safety rules.....	3
Safety symbols.....	10
Technical specifications.....	10
Package Contents.....	11
Assembly.....	11
Operation.....	16
Maintenance.....	16
Troubleshooting guide.....	16
Warranty.....	17

## SAFETY RULES

---



### WARNING

To avoid serious personal injury, do not attempt to use this product until you read the manual thoroughly and understand it completely. Save this manual and review frequently for continuing safe operation and instructing others who may use this tool.

### Before Use

1. **For safe handling of this product, the user must have read and understood the instructions for use before using it for the first time.**
2. **Observe all safety instructions!** If you do not observe the safety instructions you will endanger yourself and others.
3. **Keep all instructions for use and safety instructions for future reference.**
4. **Attach the instructions for use, if you pass on the product.**
5. **KEEP WORK AREA CLEAN.** Cluttered areas and benches invite accidents.
6. **All parts of the product, safety devices in particular, must be correctly installed to ensure faultless operation.**

### OPERATION/WORKPLACE

1. **KEEP GUARDS IN PLACE** and in working order.
2. **REMOVE ADJUSTING KEYS AND WRENCHES.** Form habit of checking to see that keys and adjusting wrenches are removed from tool before turning it on.
3. **KEEP CHILDREN AWAY.** All visitors should be kept safe distance from work area.
4. **MAKE WORKSHOP KID PROOF** with padlocks, master switches, or by removing starter keys.
5. **DON'T FORCE TOOL.** It will do the job better and safer at the rate for which it was designed.
6. **USE RIGHT TOOL.** Don't force tool or attachment to do a job for which it was not designed.
7. **DON'T OVERREACH.** Keep proper footing and balance at all times.
8. **REDUCE THE RISK OF UNINTENTIONAL STARTING.** Make sure switch is in off position before plugging in.
9. **DIRECTION OF FEED.** Feed work into a cutting disc against the direction of rotation of the blade or cutter only.
10. **NEVER LEAVE TOOL RUNNING UNATTENDED. TURN POWER OFF.** Don't leave tool until it comes to a complete stop.

## SAFETY RULES

---

11. **The product may be used only when in a faultless condition.** If the product or part of the product is defective, have it repaired by an expert.
12. **Always follow the applicable national and international safety, health and labour regulations.**
13. **The product may only be put into operation if no faults are found during the inspection.** Ensure that any defective parts are replaced before the product is used again.
14. **Position the product horizontally on a rigid, even surface with adequate load-bearing capacity.**
15. **Do not leave any tools, objects or cables lying in the working range of the device.**
16. **Ensure that there is sufficient lighting during operation.**
17. **Assume a natural and secure stance when working.**
18. **Make sure that during operation, no body parts or clothing are caught and drawn in by rotating components.**
19. **The immediate environment must be free of combustible and other flammable or explosive substances.**
20. **Young people under 18 years of age and users who are not sufficiently familiar with its operation must not use the product.**
21. **Persons unable to safely and carefully use the tool for physical, psychological and neural reasons must not use the product.**
22. **Work with caution and only if you are physically fit:** Working under the effects of fatigue, illness, alcohol, medication and drugs is irresponsible, as you are unable to use the product safely.

## SERVICE

1. **DISCONNECT TOOLS before servicing;** when changing accessories, such as cutting discs and the like.
2. **Have your electrical tool repaired only by qualified technicians, using only genuine spare parts.** This will maintain the safety of the electrical tool.
3. **DON'T USE IN DANGEROUS ENVIRONMENT.** Don't use power tools in damp or wet locations, or expose them to rain. Keep work area well lighted.
4. **MAINTAIN TOOLS WITH CARE.** Keep tools sharp and clean for best and safest performance. Follow instructions for lubricating and changing accessories.

## SAFETY RULES

---

- 5. CHECK DAMAGED PARTS.** Before further use of the tool, a guard or other part that is damaged should be carefully checked to determine that it will operate properly and perform its intended function - check for alignment of moving parts, binding of moving parts, breakage of parts, mounting, and any other conditions that may affect its operation. A guard or other part that is damaged should be properly repaired or replaced.
- 6. Only the maintenance work and troubleshooting activities described in this instructions for use may be carried out.** All other work must be carried out by an expert.
- 7. Conversions, unauthorized modifications and the use of non-approved parts are prohibited.**

### PRODUCT-SPECIFIC SAFETY WARNINGS

- 1. Make sure that you always stand to the side of the cutting disc.**
- 2. WEAR PROPER APPAREL.** Do not wear loose clothing, gloves, neckties, rings, bracelets, or other jewelry which may get caught in moving parts. Nonslip footwear is recommended. Wear protective hair covering to contain long hair.
- 3. ALWAYS USE SAFETY GLASSES.** Also use face or dust mask if cutting operation is dusty. Everyday eyeglasses only have impact resistant lenses, they are NOT safety glasses.
- 4. USE RECOMMENDED ACCESSORIES.** Consult the owner's manual for recommended accessories. The use of improper accessories may cause risk of injury to persons.
- 5. NEVER STAND ON TOOL.** Serious injury could occur if the tool is tipped or if the cutting tool is unintentionally contacted.
- 6. Use only cutting discs that are suitable for the product.**
- 7. Only use faultless cutting discs.** Dismount damaged or worn cutting discs immediately.
- 8. Never use segmented cutting discs.**
- 9. Faults in the machine, including guards or diamond discs, should be reported as soon as they are discovered.** Never use the machine without the guard in position.
- 10. Do not twist or bend workpieces.**
- 11. Never cut several workpieces simultaneously - and do not cut bundles made of several individual pieces.** A workpiece can get caught in the cutting disc and fly out of control.
- 12. Never cut workpieces on which there are ropes, cords, bands, cables or wires containing such materials.**

## **SAFETY RULES**

---

- 13. Make regular checks to ensure that the cutting disc is correctly fastened.**
- 14. Make sure that during the cutting operation, an adequate quantity of cooling water reaches the cutting surfaces of the disc at all times.**
- 15. Never cut wood or metal with this saw.**
- 16. Always maintain sufficient distance from the cutting disc.** Switch off the product and wait until the cutting disc stops before removing workpieces, residual material etc. from the work area.
- 17. Always pull out the mains plug (disconnect the product from its power supply) before commencing work on the product.**
- 18. A cutting disc can cause injuries, even when stationary!** Use protective gloves to change the cutting disc.
- 19. Never use lateral counter pressure to bring the cutting disc to a standstill after switching off the drive.**
- 20. Replace table insert when worn.**
- 21. Use only diamond discs recommended by the manufacturer.**
- 22. Never use blades on this machine.**
- 23. Use only diamond discs for which the maximum possible speed is not less than the maximum spindle speed of the tool and the material to be cut.**
- 24. Maximum size of working piece should be 1m<sup>2</sup>.**
- 25. This tile saw should be used at an ambient temperature only (between 15°C and 30°C).**
- 26. USE PROPER EXTENSION CORD.** Make sure your extension cord is in good condition. When using an extension cord, be sure to use one heavy enough to carry the current your product will draw. An undersized cord will cause a drop in line voltage resulting in loss of power and overheating. Table C on page 9 shows the correct size to use depending on cord length and nameplate ampere rating. If in doubt, use the next heavier gauge. The smaller the gauge number, the heavier the cord.

## **STORAGE AND TRANSPORT**

- 1. Always store the product in a dry place.**
- 2. Store the product in a frost-free place.**
- 3. Protect the product from damage during transport.**
- 4. Keep the product away from children.** Store the product in a place where it is safe from children and unauthorized persons.

## SAFETY RULES

---

### RESIDUAL RISKS

Even when the product is used properly and in compliance with all the safety precautions in these instructions for use, the following residual risks can arise:

- Touching the cutting disc in the exposed area.
- Reaching into the spinning cutting disc.
- Rebound from workpieces and workpiece parts.
- Cutting disc breaks.
- Faulty cutting disc diamond attachment being flung out.
- Hearing damage through failure to wear the requisite hearing protection.

### WARNING

For your own safety read instruction manual before operating saw.

- Wear eye protection.
- Use splash hood for every operation for which it can be used.
- Disconnect saw before servicing, when changing cutting wheels, and cleaning.
- Use tool only with smooth edge cutting wheels free of openings and grooves.
- Replace damaged cutting wheel before operating.
- Do not fill water tank above water fill line.
- Do not expose to rain or use in damp locations.

### ELECTRICAL SAFETY

#### A. GROUNDING INSTRUCTIONS (FIG. A)

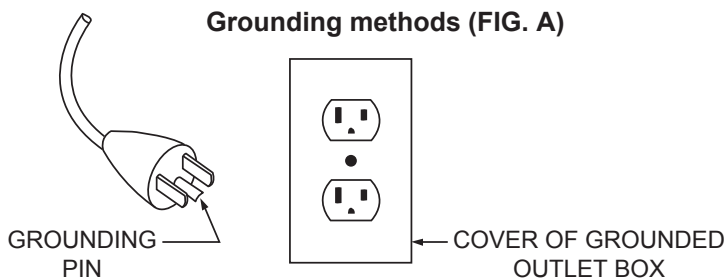

In the event of a malfunction or breakdown, grounding provides a path of least resistance for electric current to reduce the risk of electric shock. This tool is equipped with an electric cord having an equipment-grounding conductor and a grounding plug. The plug must be plugged into a matching outlet that is properly installed and grounded in accordance with all local codes and ordinances.

Do not modify the plug provided - if it will not fit the outlet, have the proper outlet installed by a qualified electrician.

Improper connection of the equipment-grounding conductor can result in a risk of electric shock. The conductor with insulation having an outer surface that is green

## SAFETY RULES

---

with or without yellow stripes is the equipment-grounding conductor. If repair or replacement of the electric cord or plug is necessary, do not connect the equipment-grounding conductor to a live terminal.

Check with a qualified electrician or service personnel if the grounding instructions are not completely understood, or if in doubt as to whether the tool is properly grounded.

Use only 3-wire extension cords that have 3-prong grounding plugs and 3-pole receptacles that accept the tool's plug.

Repair or replace damaged or worn cord immediately.

### B. POSITION OF TILE SAW (FIG. B)

#### DRIP LOOP (FIG. B)

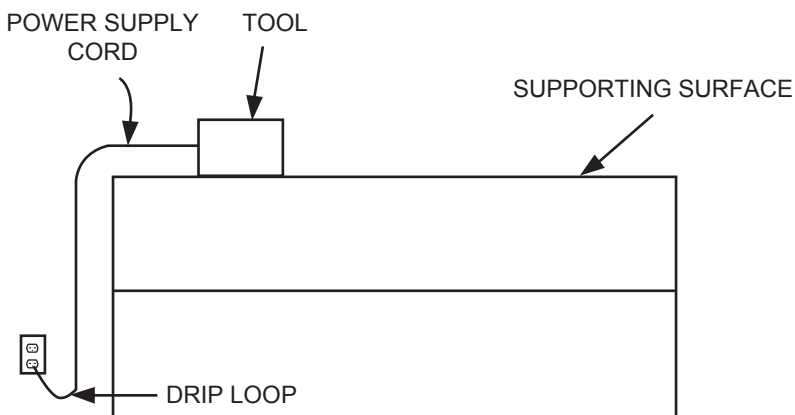

1. To avoid the possibility of the appliance plug or receptacle getting wet, position tile saw to one side of a wall mounted receptacle to prevent water from dripping onto the receptacle or plug. The user should arrange a "drip loop" in the cord connecting the saw to a receptacle. The "drip loop" is the part of the cord below the level of the receptacle, or the connector if an extension cord is used, to prevent water traveling along the cord and coming in contact with the receptacle.
2. If the plug or receptacle does get wet, DON'T unplug the cord. Disconnect the fuse or circuit breaker that supplies power to the tool. Then unplug and examine for presence of water in the receptacle.



## SAFETY RULES

---

### C. EXTENSION CORDS (FIG. C)

#### Minimum gauge for extension cords (FIG. C)

Ampere Rating		Volta	Total length of cord in feet			
		120 V	25 ft	50 ft	100 ft	150 ft
More Than	Not More Than	AWG				
0	6		18	16	16	14
6	10		18	16	14	12
10	12		16	16	14	12
12	16		14	12	Not Recommended	

1. Use only extension cords that are intended for outdoor use. These extension cords are identified by a marking "Acceptable for use with outdoor appliances; store indoors while not in use." Use only extension cords having an electrical rating not less than the rating of the product. Do not use damaged extension cords. Examine extension cord before using and replace if damaged. Handle extension cords carefully; do not yank on any cord to disconnect. Keep cord away from heat and sharp edges. Always disconnect the extension cord from the receptacle before disconnecting the product from the extension cord.
2. **WARNING** - To reduce the risk of electrocution, keep all connections dry and off the ground. Do not touch plug with wet hands.
3. Ground Fault Circuit Interrupter (GFCI) protection should be provided on the circuit(s) or outlet(s) to be used for the tile saw. Receptacles are available having built-in GFCI protection and may be used for this measure of safety.

## EXPLANATION OF SYMBOLS

---



Conforms to United States  
and Canadian standards



Wear ear protection



Read instructions before use



Wear eye protection



Risk of electric shock



Wear suitable face mask



Risk of injury when instructions  
are not followed



Wear gloves



Wet conditions alert



Waste electrical products should  
not be disposed of with household  
waste

## TECHNICAL SPECIFICATIONS

---

Code	G02772
Model	TC180VI
Voltage	120V~ 60Hz 4.6AMP
No load speed	3590 RPM
Insulation class	Class I
Dimensions of the diamond disc	7" x 5/8" (180 x 16 mm)
Working table size	13-9/16" x 16" (345 x 405 mm)
Maximum cutting depth	1-3/16" (30 mm) at 90°
Max. workpiece thickness for 45° jolly cut	3/5"(14 mm)
Net weight	24.5 lbs (11.1 kg)

## PACKAGE CONTENTS

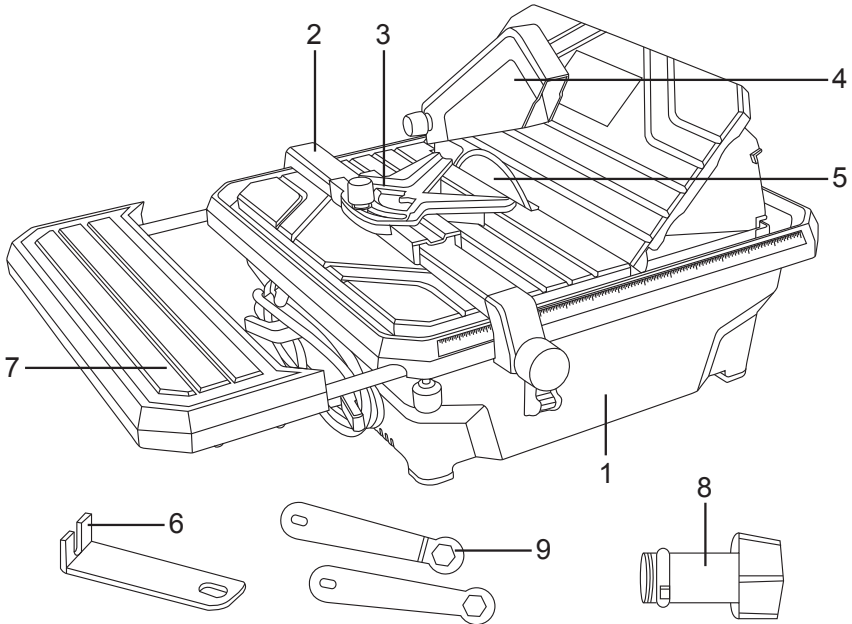

PART	DESCRIPTION	QUANTITY
1	Tile saw (assembled)	1
2	Rip Fence	1
3	Miter Guide	1
4	Upper Blade Guard	1
5	Saw Blade	1
6	Metal Bracket	1
7	Extension table and locking knob	1
8	Water Reservoir Plug	1
9	Sapnner	2

## ASSEMBLY

This tile saw must only be used only to cut tiles to a required size or shape. It shall not be used to cut inflammable, explosive or toxic materials. Other uses for the machine will lead to the damage of the machine and a series of dangers to the operator. This tool is for private and household use, not for professional or industrial ones. Only identical accessories as the ones provided with the tile saw are authorized. Never use the appliance in the rain or other wet conditions.

## ASSEMBLY

### Unpacking

- Remove all packaging materials.
- Remove remaining packing and package inserts (if included).
- Check that the package contents are complete.
- Check the appliance, the power cord, the power plug and all accessories for transportation damage.
- Keep the packing materials as long as possible until the end of the warranty period.



### WARNING

Packaging materials are not toys! Children must not play with plastic bags!  
Danger of suffocation!

### INSTALLATION OF THE METAL BRACKET

#### (Fig. 1 and 2)

- Unplug the tile cutter from the mains supply.
- Remove the cover (45° vertical fence) of the water reservoir.
- Remove the two screws and washers from the top of the deck, slide the metal bracket into the desired position and then fix in place re-using the two screws and washers. Ensure the bracket is perpendicular to the deck and positioned inline with the blade.
- Loosening these screws allows some minor adjustment to ensure the bracket does not foul the tile when cutting.
- Put the cover (45° vertical fence) back into position.

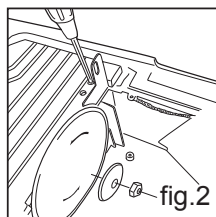
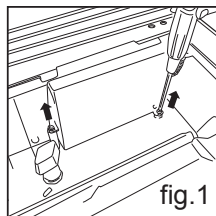

### INSTALLATION OF THE DIAMOND DISC

#### (Fig. 2 and 3)

- Unplug the tile cutter from the mains supply.
- Remove the cover (45° vertical fence) of the water tank.
- Insert the inner flange, the diamond disc and the outer flange on the spindle then tighten the bolt clockwise with the two spanners provided.
- Insert the blade lower guard with the chain into the notches then tighten the screw.
- Put the metal cover back into position.

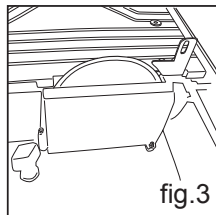

### WARNING !

Be sure to observe the rotational direction of the cutting disc when fitting! Be sure to observe the free-wheeling of the cutting disc when fitting!

### INSTALLATION OF THE PROTECTIVE GUARD (Fig. 4)

- Loosen the locking knob (1) and remove the locking knob, flat washer (2) and hex bolt (3) from the upper protective guard (4).
- Align upper protective guard (4) with cutting disc and slide over metal bracket (5). Line up through holes in upper protective guard with slot in metal bracket.
- Install hex bolt (3) through upper protective guard and metal bracket. Put the flat washer (2) onto bolt before the thread locking knob (1) and tighten the locking knob.
- Cover the cutting disc with the upper protective guard (4).
- Ensure that upper protective guard (4) can move freely and that it cannot touch the cutting disc.

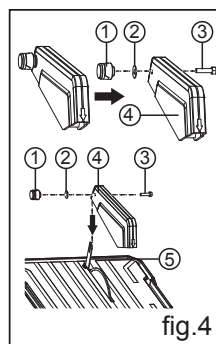

#### **WARNING !**

The metal bracket must always be aligned to the cutting disc so that it does not interfere with material being cut.

#### **WARNING !**

Product damage! Do not over-tighten hex bolt (3) and locking knob (1). The upper protective guard (4) must be free to rise and fall as the workpiece is pushed toward the cutting disc.

### INSTALLATION OF THE PARALLEL GUIDE (Fig. 5)

- Attach the rear end of the parallel cutting guide (1) to the rear of the working table.
- Push the spring (2), clamp (3) and flat washer (4) onto thread (5).
- Screw locking knob (6) onto thread (5) and turn it clockwise to tighten securely.

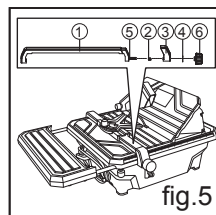

### ADJUSTING THE PARALLEL CUTTING GUIDE

- Gently turn locking knob on parallel cutting guide counter-clockwise to loosen.
- Use parallel cutting guide scale, located on front and rear of working table, to set parallel cutting guide to desired width of cut.
- Turn locking knob clockwise to tighten securely.

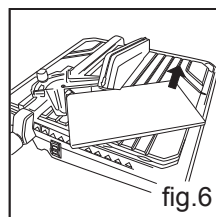

### MITER OR DIAGONAL CUT (Fig. 6)

- Mitre cutting can be performed by using the mitre cutting guide. The angle can be adjusted from 0° to 45° by unscrewing the plastic screw.

## ASSEMBLY

### ANGLE OR BEVEL CUT (Fig. 7)

- To perform 22.5° or 45° bevel cutting, raise one side of the table, lever out the support and locate the tabs into the corresponding holes in the deck. Ensure that the deck is correctly secured before working.

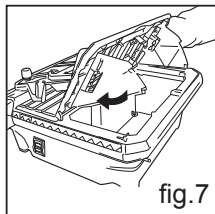

### INSTALLING THE WATER RESERVOIR PLUG (Fig. 8)

- Raise the 45° vertical fence approx. 45° and remove.
- Locate hole on bottom of water fill reservoir.
- Push water reservoir plug (1) into hole firmly.
- Replace 45° vertical fence.

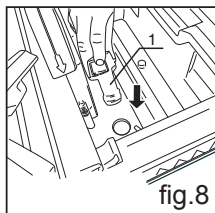

### MOUNTING THE EXTENSION TABLE (Fig. 9)

- Undo the cross-screws (1) on the guide rails of the extension table (2).
- Push the guide rails for the extension table (2) on both sides into the locator of the machine body.
- Refit the cross-screws (1).
- Mounting the locking knob (3).

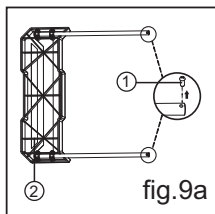

### SETTING EXTENSION TABLE (Fig. 9c)

- Loosen the locking knob counter-clockwise.
- Set the extension table to the desired distance from the cutting disc.
- Tighten the locking knob clockwise.

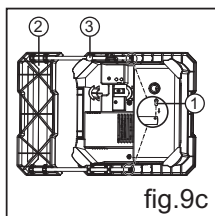
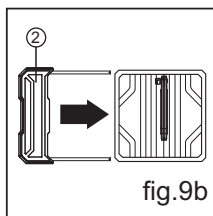

### ON/OFF SWITCH (Fig. 10)

- To turn the tile saw On, insert the safety key (1) into the switch housing. As a safety feature, the switch cannot be turned On without the key.
- Flip the switch upward to the On position.
- To turn the tile saw Off, move the switch to the down position.
- To lock the switch in the Off position, remove the safety key from the switch. Store the key in a safe place.

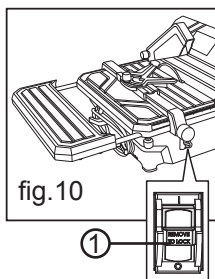

## ASSEMBLY

### FILLING THE WATER RESERVOIR (Fig. 11)

- Raise the 45° vertical fence approx. 45° and remove.
- Push water reservoir plug into hole firmly.
- Fill the reservoir with water only until water can drain from the opening in the plug.
- Ensure that water just cover the disc edge (no more than  $\frac{1}{4}$  of the disc is submerged in water).
- Replace 45° vertical fence.

### TO CHANGE RESERVOIR WATER

- Unplug tile saw.
- Remove the water reservoir plug and empty into a bucket do not allow water to splash onto ground or around machine.
- Discard waste water in accordance with local regulations.



#### CAUTION!

- Fill the product with water only until water can drain from the opening in the plug. During use the water level must never drop below the MIN marking (1). (Fig. 11)
- Product damage! Fill the tank only with clear water. Never use chemicals or cleaning agents. This can cause irreparable damage to the product.

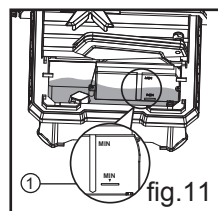

### CONNECTION TO THE ELECTRICAL SUPPLY

Before switching on, make sure that the voltage of the mains supply is the same as indicated on the rating plate. This product is designed to operate on 120V~60Hz.

Connecting it to any other power source may cause damage.

This appliance must be properly grounded. If in doubt, please consult a qualified electrician. The mains supply shall be fed via a 10 amp min. fuse. Put the tile saw on a clean, stable and flat surface.

**WARNING !** Before switching the tile saw on, make sure that you have read and understood all of the safety instructions. Make sure that the tile saw is unplugged when the tile saw is not being used or adjustments are being made.

**WARNING !** The disc will continue to rotate for a few seconds after the machine has been switched off. Wait for the disc to stop before removing the workpiece or making any adjustments.

Stop the machine immediately if there is undue vibration or some other fault. If this situation continues, check the machine to find the origin of the fault.

## **OPERATION**

---

### **MAKING A STRAIGHT CUT**

Adjust the parallel guide to the desired width. Use the securing knob to loosen or adjust the guide.

Position the tile firmly against the parallel guide and pass through the blade in a smooth action.

Hold the edges of the tile and press down firmly to prevent the tile lifting during the cut.

### **MAKING A MITRE OR DIAGONAL CUT**

Follow the same procedure for a straight cut but use the mitre cutting guide in conjunction with the parallel guide. The mitre cutting guide simply clips onto the parallel guide.

Make sure that the tile is held firmly in the guide before making the cut.

### **CUTTING AN ANGLE OR BEVEL**

Use the 45° vertical fence if you wish to cut an angle or bevel on the tile edge. Lift the 45° vertical fence inserting the plastic tabs into the corresponding holes on the table. Then make the cut as before.

Internal or external bevel cuts can be made by turning the tile face up or down (internal – eg. Wall corner; external – eg. window reveal).

## **MAINTENANCE**

---

Make sure that the saw is turned off and unplugged from power source before installation, before cleaning and maintenance operations.

Apart from diamond discs, there are no other user serviceable parts inside this tile saw. Refer to qualified service personnel if internal maintenance is required. Any worn, or damaged parts should be replaced immediately by qualified personnel. Keep discs in good condition. Poor condition or worn discs can increase the noise level emitted.

Do not allow dust to accumulate inside, or on the product. After use, clean all excess dust from the table and the area around the table. Frequently clean the machine using a soft brush or vacuum cleaner.

## **TROUBLESHOOTING GUIDE**

---



### **Danger of death!**

Improper repairs can result in the product functioning unsafely.

This endangers yourself and your environment.

Malfunctions are often caused by minor faults. You can easily remedy most of these yourself. Please consult the following table. You will save yourself a lot of trouble and possibly money too.



## TROUBLESHOOTING GUIDE

---

SYMPTOM	POSSIBLE CAUSE(S)	CORRECTIVE ACTION
Motor not running.	No mains voltage?	Check cable, plug, socket and fuse.
Motor runs, cutting disc remains still when subject to load.	Flange nut loose?	Check the flange is seated correctly and tighten if necessary.
Cutting disc runs irregularly/vibrates.	1. Cutting disc warped? 2. Cutting disc fitted incorrectly?	1. Replacing the cutting disc. 2. Fit the cutting disc correctly.
Cutting disc is discoloured.	1. Insufficient cooling water? 2. Lateral friction caused by cut runout?	1. Filling the product with water. 2. Guide workpiece through cutting disc more slowly.

## ONE-YEAR LIMITED WARRANTY

---

The manufacturer warrants this item against defects in materials and workmanship for one (1) years from the date of purchase. If within this period the product is found to be defective in material or workmanship, the manufacturer will, at its option, repair, replace or refund the original purchase price to the customer. Please keep the original sales receipt as proof of purchase and call 1-877-876-7562, 8 a.m. – 5 p.m., CST, Monday – Friday for warranty service.

This warranty is void if product is used for commercial purposes. This warranty is not transferable and does not cover products damaged by misuse, neglect, accident, alterations or use and maintenance other than that specified in the owner's manual. This warranty does not apply to any expendable parts that can wear from normal use.

As some states do not allow exclusions or limitations on an implied warranty, the above exclusions and limitations may not apply to you. This warranty gives you specific legal rights, and you may have other rights that vary from state to state.