



Framed Floor Vent

INSTALL GUIDE



Scan to unlock
your free warranty

Or — on your phone?
Press + hold the QR code to
go straight there.

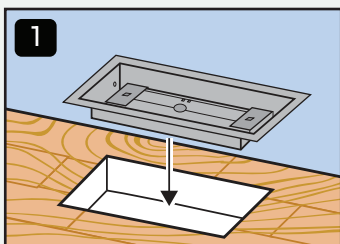

Dry fit **body** in opening.

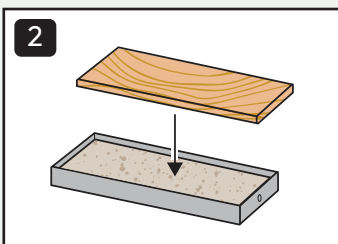

Apply adhesive bonding material
in **tray**. Insert flooring material.

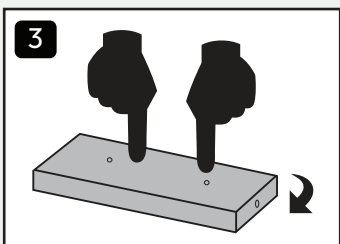

Flip **tray** upside down. Apply even
pressure until flooring material lies
flat with rim of **tray**.

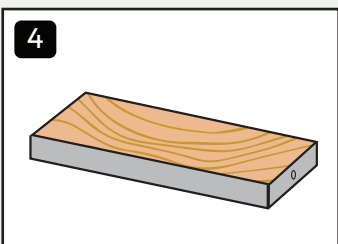

Wait to cure.

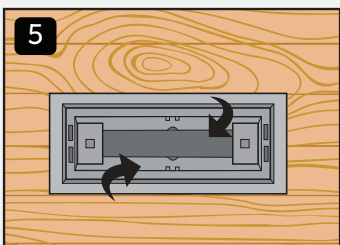

To adjust airflow, remove **tray** and
bend dampers. For optimal air
flow, push dampers past 90°.

For **Lite** versions of this product,
dampers are not included. Optional
dampers are sold separately.

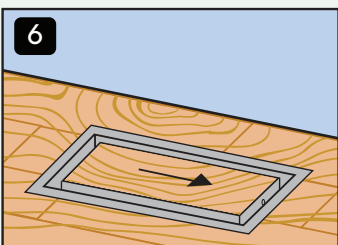

Insert **tray** in place. That's it! Fittes
to perfection.



Framed Floor Vent [Luxe+]

INSTALL GUIDE



Scan to unlock
your free warranty

Or — on your phone?
Press + hold the QR code to
go straight there.

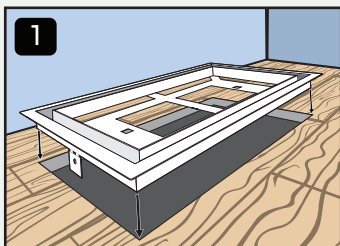

Dry fit **body** in opening.

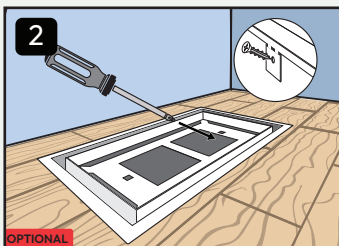

Secure with screws.

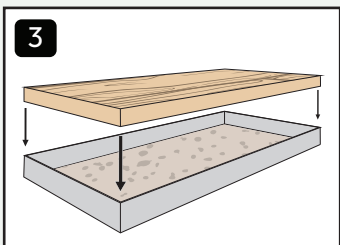

Apply adhesive bonding material in **tray**. Insert flooring material.

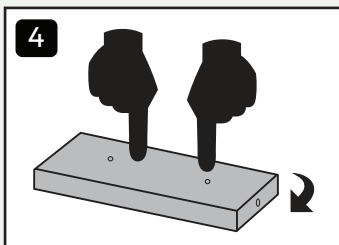

Flip **tray** upside down. Apply even pressure until flooring material lies flat with rim of **tray**.

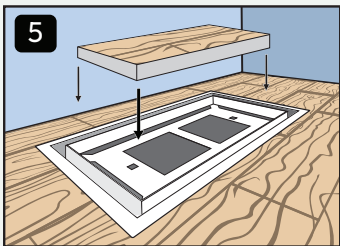

Insert **tray** into the body.

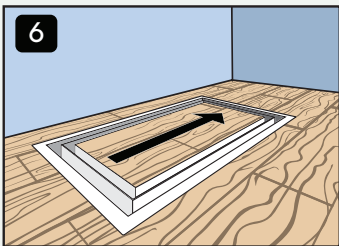

Slide in place. That's it! Fittes to perfection.