



SENTINEL CEMENT FOAM BOARD  
TABLERO DE ESPUMA DE CEMENTO SENTINEL



SENTINEL CEMENT FOAM BOARD is made from extruded polystyrene foam, reinforced with fiberglass and polymer mortar on both sides. It can be directly installed on stud framing, and it's an ideal board to replace plasterboard or cement board to create shower walls.

SIZE, PACKAGING & WEIGHT

SKU	MODEL NO.	BOARD SIZE	WEIGHT (lbs/ctn)	PER BOX
100819135	FBSENJT366019-1	3'x5'x1/2"	69.3	5
100819143	FBSENJT489619-3	4'x8'x1/2"	138.9	5



## PRODUCT DESCRIPTION

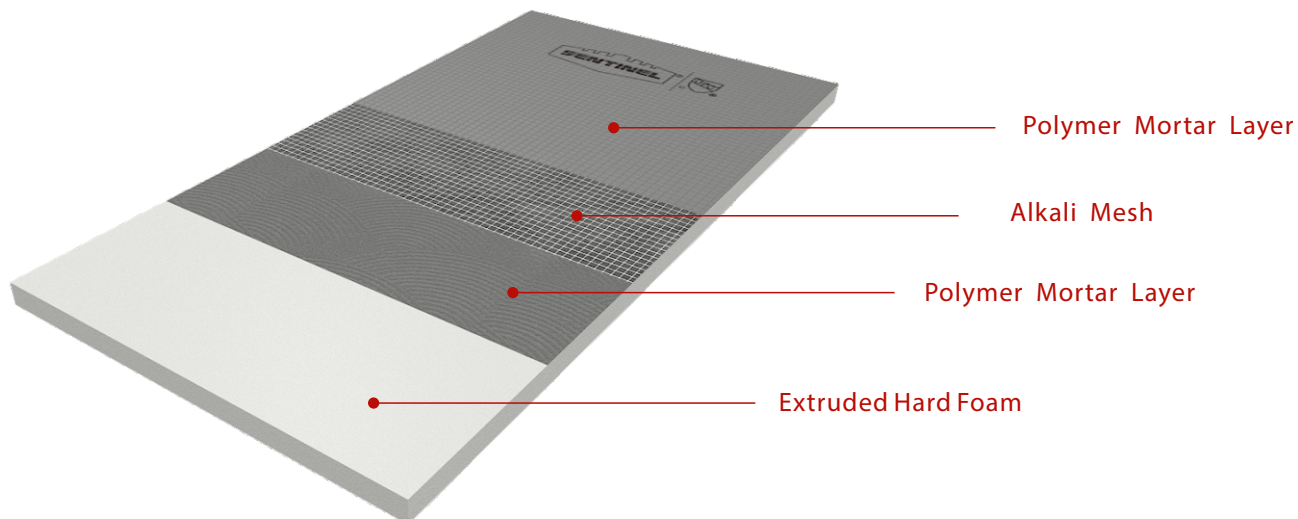

## SENTINAL CEMENT FOAM BOARD VS CEMENT / PLASTERBOARD



VS

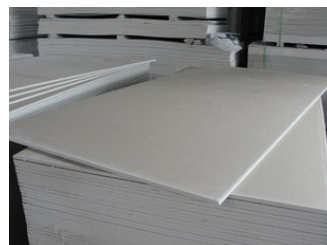

### BENEFITS:

- Fully waterproof
- Heat insulating
- Light weight, easy to fix
- Acts as a de-coupling and thermal insulation barrier with underfloor heating systems

### SUITABLE FOR:

- Waterproofing wet rooms and showers
- All types of tiles
- For walls and floors

## PARTS REQUIRED



- 1 Tile Backer Board
- 2 Shower Niche
- 3 Felt Pipe Seal
- 4 Felt Valve Seal
- 5 Waterproofing Seam Tape  
Size: 5" x 16' 5"



- 6 Stainless Steel Washers/Stainless Steel Screws

Stainless Steel Washers  
Size:  $\varnothing=1-3/8"$



Stainless Steel Screws  
Size: 1-5/8"

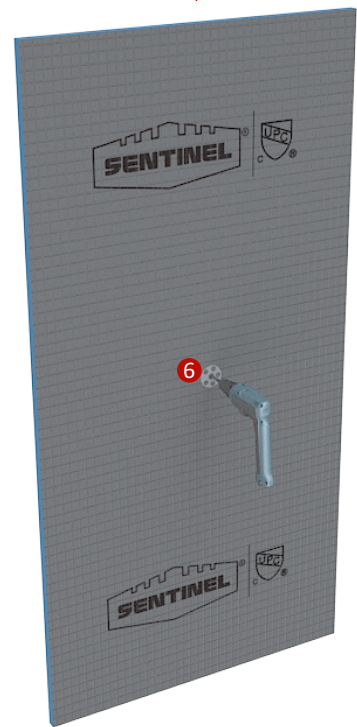

### TILING

SENTINEL CEMENT FOAM BOARD are the ideal surface to tile on. They bond with all proprietary tile adhesives, so all you need to do is choose the correct adhesive for fixing the ceramic or natural stone tiles. If in doubt seek further advice from the tile adhesive and grout manufacturer.

Don't forget that for a wet area installation you need to achieve a solid bed of adhesive, ensuring no voids are left beneath the tiles.

### CUTTING AND HANDLING

SENTINEL CEMENT FOAM BOARD can be cut easily with a utility knife. Even the largest boards can be handled and fixed by one person. The cut edge of a board can be rough, so suitable gloves should be worn.



## INSTALLATION



1. Cutting the SENTINEL CEMENT FOAM BOARD into suitable size.

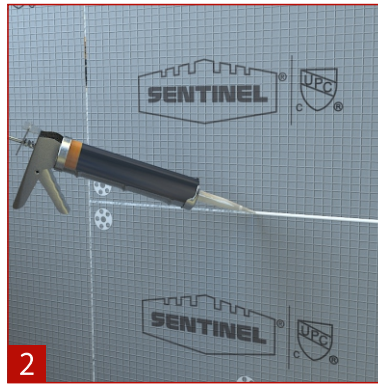

2. Apply polyurethane adhesive on the joints which are between the boards.

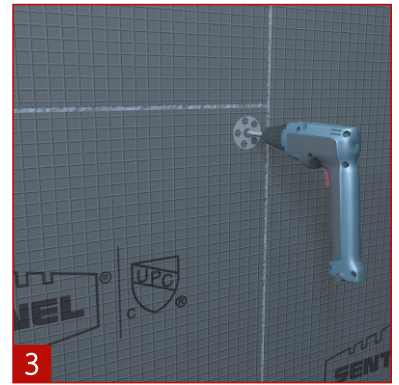

3. Fasten the board to a stud using Sentinel Stainless Steel Washers and Screws.

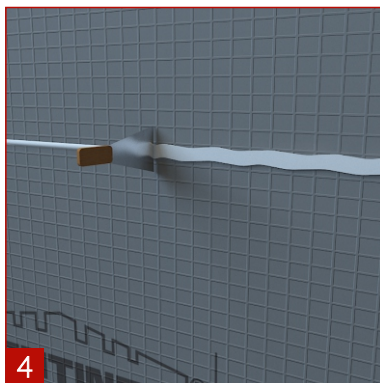

4. Use a putty knife to spread polyurethane adhesive flat over all joints.

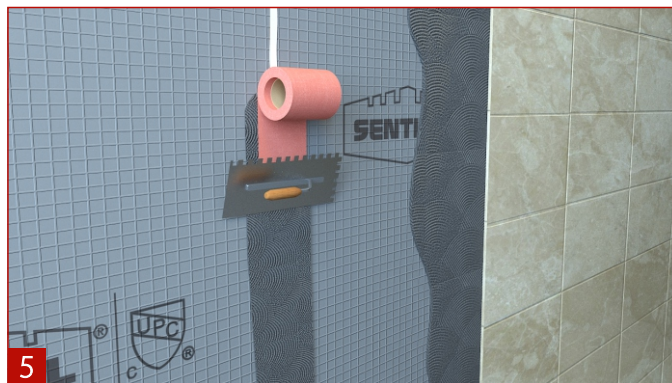

5. To help avoid leaks, cover all joints with Sentinel Waterproofing Seam Tape.

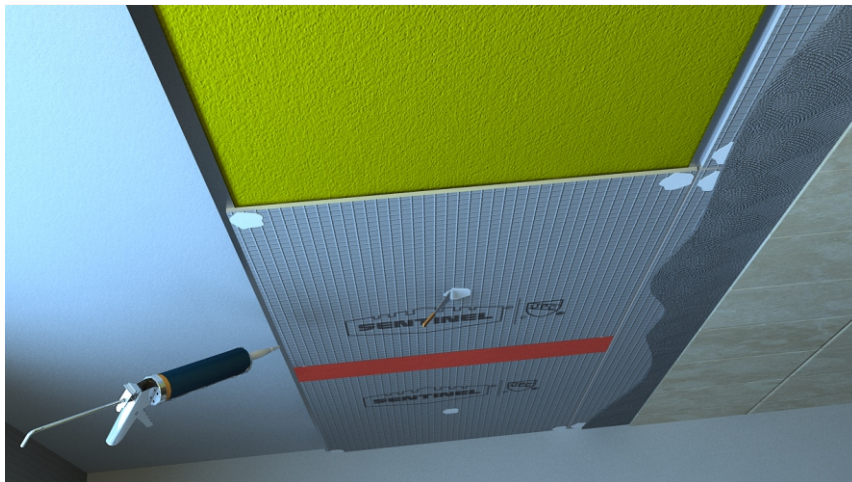

DISTRIBUTED BY [FLOORANDDECOR.COM](http://FLOORANDDECOR.COM)