

STOP!



The TimberClick® Product that you have purchased is a proprietary brand of Locking Solid Hardwood Flooring and has very specific acclimation and installation requirements. Before you proceed, be sure to familiarize yourself with all of the requirements necessary for a successful installation.

If you have any question about your TimberClick® product, installation, acclimation or warranty requirements, please call the below number!

1-888-271-3859

Installation Instructions – TimberClick® Solid Wood Locking Flooring

NOTE: Wood floors are not suitable for rooms that are subject to excessive moisture and high levels of humidity.

Important notice

All wood is hygroscopic (reacts to the moisture in the environment) and as a result will expand or contract accordingly. All sources of moisture must be rectified prior to the installation of the floor, and moisture levels in rooms fitted with wood flooring should be maintained at a stable level, in line with normal living conditions.

It is important that you check each plank for any manufacturing defects. Any defects must be reported back to the store of purchase or to customer care for an immediate refund or replacement prior to the flooring being installed. The boards in this pack are of random lengths and should be laid randomly across the floor to create the best effect. It is advisable to open a few packs at a time to mix boards from each pack as they are installed.

NOTE: This is a solid wood locking floor. It is critical that the home humidity levels remain no lower than 45% and no higher than 60%.

Before You Start

- Calculate the total square meters or square footage of the room(s) and add 10% for cutting and waste.
- The boxes should be placed in the room where wood is to be installed to acclimate for 72 hours. Open all boxes to allow air to circulate. The boards should be stored and laid in a relative humidity between 45%-60% and at a room temperature of between 65 degrees to 70 degrees Fahrenheit. In some High Variability Humidity markets, acclimation of up to 7 days may be needed. Do not proceed with installation until the relative humidity of the flooring planks matched the relative humidity of the installation site.
- Wood flooring is a natural product which will mature with age. The boards will change shade over time through exposure to sunlight.
- All substrates must be structurally sound, flat and dry. The surface should be free of all contaminants and loose material. All potential sources of moisture e.g. walls, drains, damp proof courses, plumbing, refrigerators, washing machines etc. MUST be thoroughly checked and rectified if found to be an issue.
- The boards should be installed lengthways towards the main incoming light source and, where possible, down the length of the room.
- Concrete subfloors must be checked for moisture. Several methods are available to test concrete, from concrete-specific moisture meters to physical methods such as calcium chloride tests. Whatever the means of testing, the emission of moisture vapor from the floor should not exceed 3 pounds per 1,000 square feet per 24 hours. Normally concrete should be at least 60 days old to meet this requirement, although flooring can be installed before that if moisture tests indicate that the slab is ready.
- For Floating installations on any concrete subfloor, a 6 mil plastic sheeting is required in addition to the underlayment (NOTE: Many underlayments already have the plastic attached).
- If installing onto a wood subfloor, TimberClick® flooring can be installed directly onto prepared floorboards. If the existing floorboards are sufficiently flat, the new boards can be laid directly on to them at 90°. If the existing floor is not suitably flat then it must be made flat and level by overlaying with Exterior Grade plywood. Loose boards must be secured or the new floor may squeak
- It is not recommended to install this product over subfloors with radiant heat as this will void the manufacturer's warranty.

NOTE: Please take care to ensure that the subfloor is smooth, flat, and clear of debris. There should be no more than 3/16" difference over an 8' span in any direction. Please use an 8" straight-edge to check. Prep subfloor as needed.

Floating Installation

NOTE: If the installation area is wider than 22 lineal feet, it is required to split installation in two to allow for an expansion / contraction gap. The expansion gap of a minimum 3/8" can be hidden with a T-molding or any transition profile of wood or metal.

- Before floating installation of the flooring begins, install a foam underlay. Run the foam underlay in the same direction as the flooring planks. The underlay should be butted side-by-side with no overlap. Tape seams together. Your floor is made to be installed floating without glue.
- Leave an open expansion gap of a minimum 3/8" around the whole perimeter of the room (using spacing distance wedges will help), also at pipes, stairs, columns, doorframes and thresholds. Install up to a maximum 22 lineal feet length / width before using a transition piece. The floor must be able to move free, or 'float'. Do not connect or install tightly to any construction part. For rooms with off square areas or L-, F-, T-, U-shapes, separate the areas with an expansion gap around the object - and always in door openings. For questions or for further information, installation at doors, floating requirements, etc. call 1-888-271-3859.
- Claims regarding visible defective floor planks must be made prior to installation. Each board should be inspected to ensure that the quality is acceptable. No claims relating to surface defects can be accepted after installation.
- In any floating installation, the installed floor must be unrestricted and free to expand and contract naturally. Proper expansion gaps are necessary. Moreover, heavy items such as cabinets should not be installed on top of the flooring, as this would prohibit the free movement of the flooring.

Floating Installation method of TimberClick®

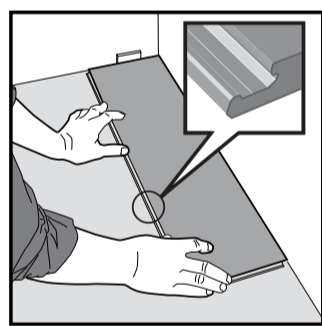

1. First plank, first row. Place a distance of 3/8" (10mm) width to the left and position the plank against the wall. After 3 rows, you can easily position the flooring on the front wall with 3/8" (10mm) expansion gap.

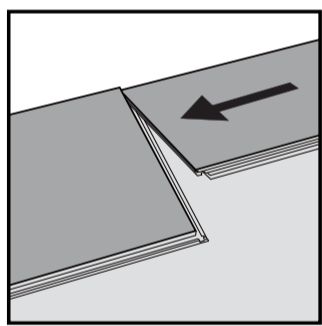

2. Second plank, first row. Place this plank tight to the short end of the first one.

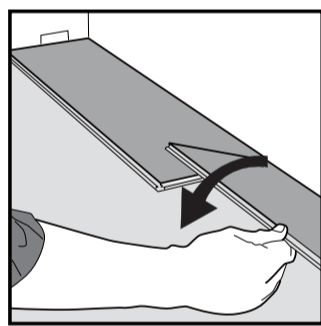

3. Fold down with a single action movement.

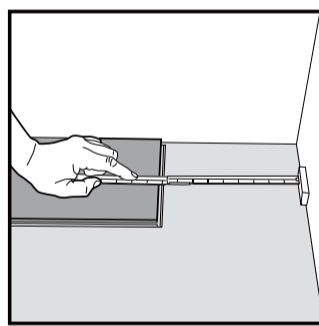

4. At the end of the first row, leave an expansion gap of 3/8" (10mm), to the wall and measure the length of the last plank to fit.

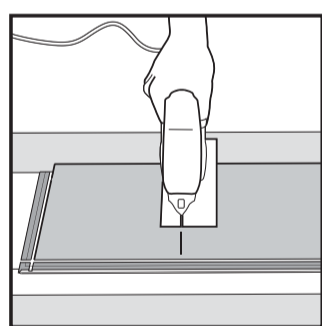

5. Cut with a jig saw – hardwood turned down or with a hand saw with the hardwood visible.

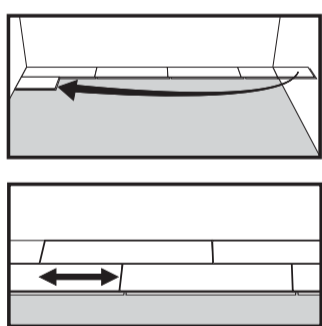

6. Second row, first plank min length 1ft 7 11/16" (500mm). Leave an expansion gap of 3/8" (10mm) against the wall. Generally, minimum distance between short ends of planks in parallel rows shall not be less than 6" (150mm).

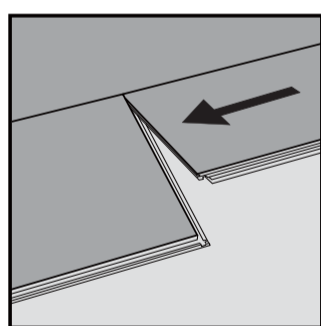

7. Second plank second row.

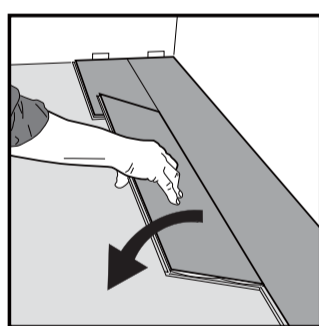

4. At the end of the first row, leave an expansion gap of 3/8" (10mm), to the wall and measure the length of the last plank to fit.

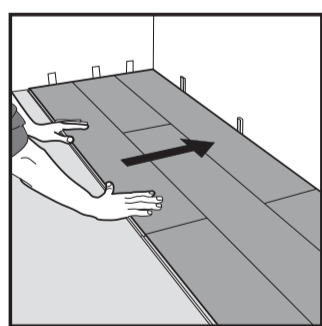

8. Place the panel tight to the short end of the previous panel and fold down in a single action movement.

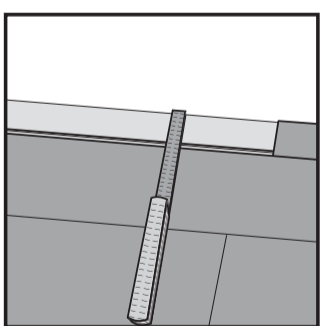

9. After 2-3 rows, adjust the distance between the front wall and the flooring by leaving an expansion gap of 3/8" (10mm).

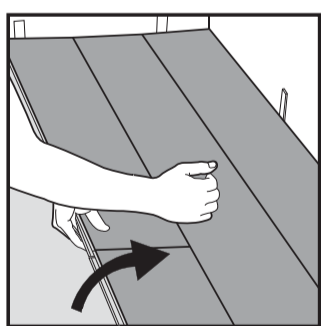

Separate the whole row by carefully lifting up and releasing the whole row. Fold up and release the whole long side.

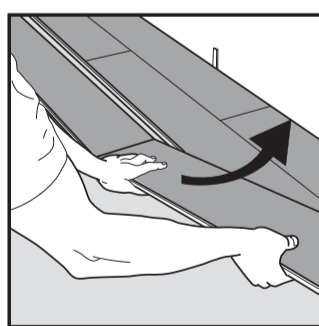

Disassemble the panels by angling the short side up vertically.

NOTE: For the first and last rows please ensure that the width of the plank is no less than 2". Remember expansion gap of 3/8".

Finishing

Once the flooring is installed, whichever method you have used, the expansion gap can be covered by re-fitting the base boards and/or with quarter round transition pieces. At doorways a door threshold strip should be used to protect the edges of the floor and provide a decorative transition from one floor type to another.

These Installation instructions are manufacturer recommended guidelines for installation of TimberClick® wood flooring and may not be applicable to all environments or installations as site conditions may vary. Homeowners should consult a certified installer or NWA member prior to installation.

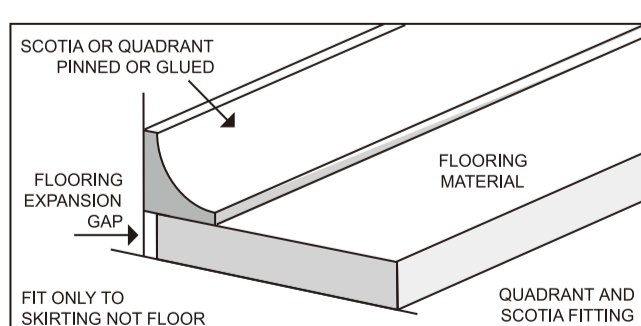

Care And Maintenance

- Hardwood flooring is a natural product. Scratches and loss of gloss are not considered as normal wear, thus preventative maintenance is important with any real hardwood floor.
- It is recommended that you use felt pads under chairs and furniture (a plastic mat should be used with office chairs on wheels).
- Rubber-based castor cups should be used for heavy load furniture such as armchairs and pianos.
- Dirt, sand, and grit will damage hardwood flooring. Doormats should be used inside and outside of all external doorways to prevent grit from being carried across the floor, protecting the surface from excessive wear and tear. Be sure that the backing of the mat is not rubber.
- For regular cleaning, a dry or damp cloth is advised. It is recommended that cloths be squeezed until no more drips are present before wiping the floor. Consult your TimberClick® retailer for recommendations of a Hardwood Floor Cleaner. Do not use abrasive cleaners, steel wool or scouring powder as this may damage the surface of your floor.
- Do not use wood oil soap products.