

# HAMPSTEAD®

WATER RESISTANT  
PREMIUM GLUELESS LAMINATE FLOORING

# HAMPSTEAD®

WATER RESISTANT  
PREMIUM GLUELESS LAMINATE FLOORING

## Water Resistant Laminate Installation Instructions

### I. Before You Start/ Preparations

**Please read all the instructions before you begin the installation. Improper installation will void warranty.**

#### Important Notice

Every application and installation is different therefore we strongly recommend the customer consult a licensed installer/contractor to verify that the conditions and application meet local requirements or industry expectations. Any installation guidelines are not intended to supersede federal, state or local regulations which may require modifying the existing installation, materials or structural components. The owner assumes responsibility for compliance with all building codes, including maintaining the required distance from heat sources such as fireplaces.

All wood based products, even those specifically designed to have increased resistance to moisture, are hygroscopic (they will react to the moisture in the environment) and as a result will expand or contract accordingly. All sources of under floor moisture must be rectified prior to the installation of the floor. Any construction dampness must be completely dry. Although this product has been designed with bathroom installation in mind it is not waterproof and excessive wetting is to be avoided and water spillages dried immediately. It is important that you check each plank for any manufacturing defects. Any faults must be reported back to the store of purchase for an immediate refund or replacement prior to the flooring being installed.

- Calculate the room surface area prior to installation and plan an extra 10% of flooring for waste.
- The floor must be installed in a dry, climate controlled, indoor environment. The room temperature must be between 60-80°F (16-27°C) before and during the installation.
- For product acclimation, cross stack unopened boxes of flooring in the installation room. If the relative humidity of the room is between 35% and 75% the product should be acclimated for a minimum of 48 hours. If the relative humidity is below 35% or above 75% the product should be acclimated for a minimum of 96 hours.
- Relative humidity levels of your room should be maintained at 35%-75% at 60-80°F (16-27°C).
- For floor surfaces exceeding 1600 sq. ft. (150 sq. m.) with lengths or widths exceeding 40 ft (12 m.) and overlaps to new rooms or floor surfaces which do not join symmetrically, use expansion joints (T-moldings) to divide the floor sections.
- For best results, make sure to always work from 2 to 3 cartons at a time and mix the planks during installation. This will result in a more natural looking floor. Do not mix flooring with different model/item/SKU numbers together in the same installation as flooring with different model/item/SKU numbers are not intended to be installed together.
- Do not install over carpet. Doing so will void the warranty.
- Inspect your subfloor before you begin. It must be clean, dry, and level to 5mm (3/16") within 3 meters (10ft) span.
- Concrete subfloors must be properly cured and allowed to dry for at least 60 days prior to installation. Test concrete subfloor for moisture before installing laminate floors.

- Maximum subfloor moisture content should be no more than 2.5% concrete (per CM method) or 12% wood. Concrete vapor emissions should not exceed 85% max (ASTM F2170) or less than 8lbs per 1000 sqft. per 24 hours MVER (Moisture Vapor Emission Rating) (ASTM F1869). This product is also not to be installed in areas that have a risk of flooding such as saunas or outdoor areas.
- If this flooring is intended to be installed over an existing wooden floor, it is recommended to repair any loose boards or squeaks before you begin installation.
- With a floating floor, you must always ensure you allow for a 3/8" (10mm) gap between walls and fixtures such as pipes and pillars, stairs, etc.
- A minimum 0.15mm (6 mil) vapor barrier must be installed over all concrete substrates. Vapor barrier edges must be overlapped by a minimum of 8" (20cm) and taped with moisture resistant tape.
- All crawl spaces must be well-ventilated. Be sure to rectify any crawl space moisture problems prior to installing flooring. Crawl spaces should be dry and meet all local building codes. Basements and crawl spaces must be dry. Ensure that crawl spaces have open vents year-round to ensure proper air circulation and prevent moisture build-up.
- An approved laminate underlayment must be used for all installations. Underlayment thicker than 3mm (1/8") is not advised and will void the warranty.
- Decide the installation direction. It is recommended to install the length direction of the planks parallel to the longest wall direction. In narrow hallways, install the floor parallel to the longest wall direction.
- Inspect every plank before installing. No claims on existing surface defects will be accepted after installation.
- Do not install cabinets or fixed objects on top of the flooring.

## IMPORTANT NOTICE

**In-Floor Radiant Heat Systems:** Flooring can be installed over 1/2" (12mm) embedded hydronic (water-based) heat systems. Radiant heat systems must have a minimum of 1/2" (12mm) separation from the product. Maximum operating temperature should never exceed 80°F (27°C). Use of an in-floor temperature sensor is recommended to avoid overheating.

- Before installing over newly constructed radiant heat systems, operate the system at maximum capacity to force any residual moisture from the cementitious topping of the radiant heat system.
- Radiant heat systems must be in operation for a minimum 3 weeks prior to installation of laminate flooring
- Maximum concrete subfloor moisture content should be no more than 2.5% (per CM method).
- Install vapor barrier and underlay as stated in this installation guide.
- Before starting the installation, turn the heat off for 24 hours before, during and 24 hours after installation.
- Make sure that the temperature in the room is between 60°F (16°C) and 80°F (27°C) during installation.
- Once the installation has been completed, the heating system should be turned on and increased gradually (5°F degree increments) until returning to normal operating conditions.

- Refer to the radiant heat system's manufacturer recommendations for additional guidance.

**Warning:** Electric heating mats are not recommended for use underneath the flooring and will void the warranty.

## II. Installation Steps

### Tools and Supplies Required

- Foam Underlayment for laminate floors • 3/8" (10mm) Spacers • Saw • Adhesive Tape • Minimum 0.15mm (6 mil) poly vapor barrier (plastic sheeting) for concrete floor installations • Rubber Mallet • Ruler • Pencil • Tape Measure • Utility Knife • Pull Bar • Tapping Block • Utility Knife • Felt protectors • NIOSH-designated Dust Mask • Gloves • OSHA Approved Safety Glasses • Hearing protection • For moisture prone areas: Flexible 100% silicone sealant and PE Foam Backer Rod

### Prior to installing flooring

After thoroughly cleaning the subfloor, you should install an approved laminate floor foam underlayment. Run the foam underlayment in the same direction as the flooring planks. The underlayment should be butted side-by-side with no overlap. Tape seams together.

**Note:** If you are installing over a concrete subfloor, a 0.15mm (6 mil) polyethylene vapor barrier is to be installed under the laminate floor foam underlayment (many foam underlayments already have this plastic sheeting pre-attached). Vapor barrier edges should be overlapped by at least 8" (20 cm) and sealed with moisture resistant tape.

*Tip: Measure the area to be installed: The board width of the first and last row shall not be less than 2.5" (6cm). If so, adjust the width of the first row to be installed. The first and last planks of rows should be at least 12" (30.5cm) long. When measuring, take the 3/8" (10mm) expansion gap requirement of the floor perimeter into account.*

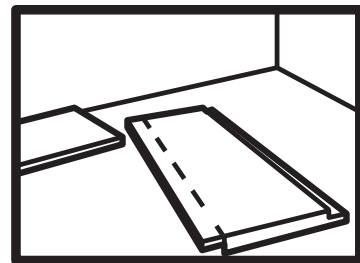
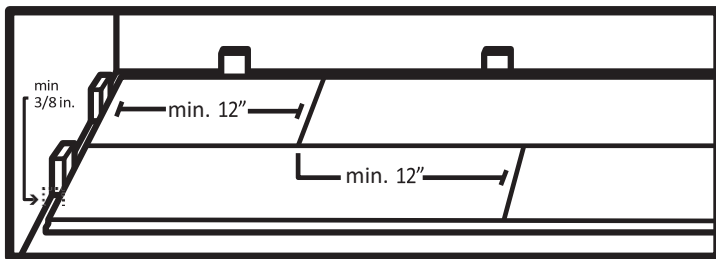

**1.** Choose starting corner and work from left to right. Lay planks tongue side facing the wall. The first and last plank of each row should be at least 12" (30.5cm) long. All joints should be staggered by a minimum of 12" (30.5 cm). Always allow for 3/8" expansion at walls and around fixed objects.

**2.** Remove the tongue side on only the planks in the first row that face the wall to allow room for spacers.

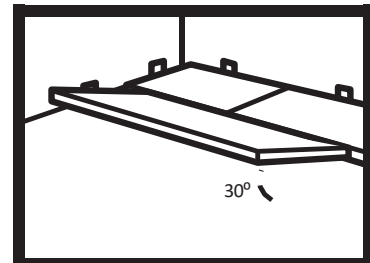
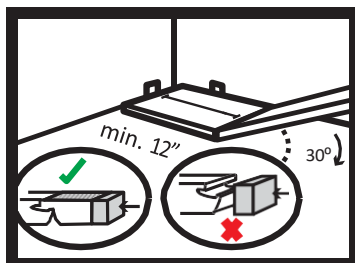

**3.** To install the first row, lock in planks by inserting the short side at an angle, then lower the plank to lock it to the previous plank. To ensure that joints are tight you will need to use the tap block and a scrap piece of flooring. Connect the scrap piece to the installed floor and place the tap block against the scrap piece, then lightly tap against the tap block.

**4.** To install the first plank of remaining rows, install its long edge edge first by inserting at an angle and lower into place to lock it to the previous row. Installing the first and second row at the same time will help ensure planks are perfectly aligned.

**NOTE:** do not tap installed planks directly. Always place a scrap piece of flooring between the tapping block and the installed planks to protect installed planks. Tap lightly and evenly against the tapping block to prevent damage.

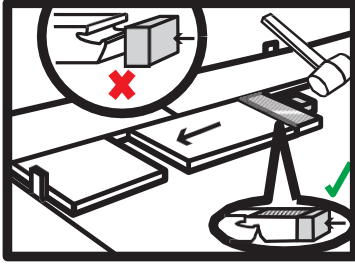

**5.** To install all remaining planks in a row, install the long side first, but before you lower it, ensure it is close to the previous plank. To connect the two planks together you will need to tap using the tap block and a scrap piece of flooring per the method described in step #3.

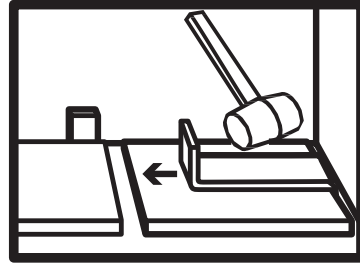

**6.** Continue in this manner until the row is complete. Use a pull bar instead of a tap block on the last plank of each row. Ensure the required 3/8" (10mm) expansion space is left between the last plank and the wall.

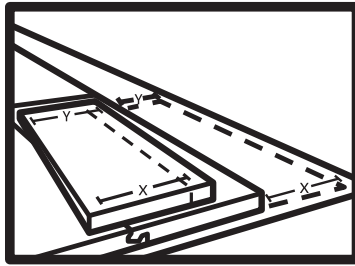

**7.** Repeat steps 4 through 6 until you reach the last row. Cut last row planks to size (2-1/2" minimum width) by measuring required depth at both ends of the plank you are cutting (X, Y). Mark a cut line between these two points and cut. Ensure the required 3/8" (10mm) expansion space is left between the last plank and the wall.

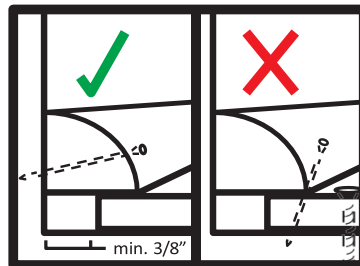

**8.** Finish the installation by removing all spacers and installing moldings and finishing trims. Do not nail trim through floor; ensure floor is able to freely float. If installing in bathrooms, laundry rooms or other areas susceptible to moisture, follow the Bathroom and laundry Room installation instructions found in this guide.

### Installation Under Doorway Frames

1. Mark door jamb with scrap piece and underlay to determine cut height.
2. Undercut door jambs using hand saw or equivalent – maintain 3/8" gap under door jamb.

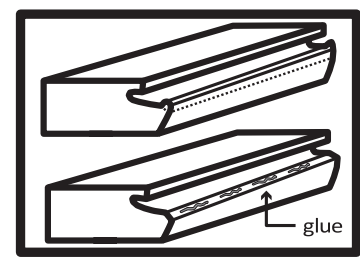
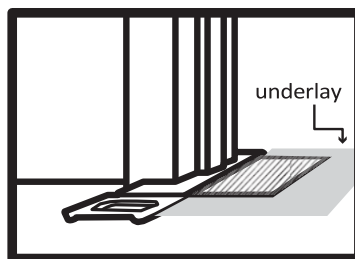

**Note:** In some areas that prevent angling planks for insertion, carefully trim the vertical member (dotted line) of the locking groove and apply a wood adhesive to hold planks together.

### Bathroom and Laundry Room Installations

It is important to seal any cut planks to ensure superior and warranted performance in moisture prone areas. When a flooring plank is cut to fit (either end cuts or side cuts), a sealant is always required around the perimeter of the installation. Once the flooring installation is completed, a 100% silicone sealant should be applied around the perimeter (in the expansion space at walls). This should also include any other areas such as islands, doorways, columns, etc. where the laminate flooring planks have been cut to fit. To limit the amount of sealant used, expansion spaces can be filled with 3/8" PE foam backer rod and then covered with silicone sealant.

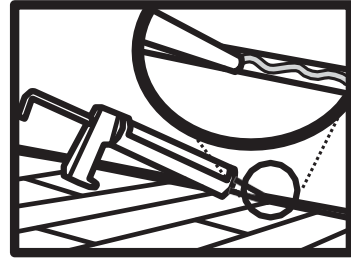

After installing planks and before installing trim, remove all spacers. Create a water tight spacing applying 3/8" PE foam backer rod and 100% flexible silicone sealant along the entire perimeter of room and around fixed objects and transitional moldings. Do not use acrylic sealant.

### III. Disassembling

Disassembling: Disengage entire row by lifting the last row delicately at an angle. To separate individual planks, leave them on the ground and then carefully slide the planks apart as illustrated.

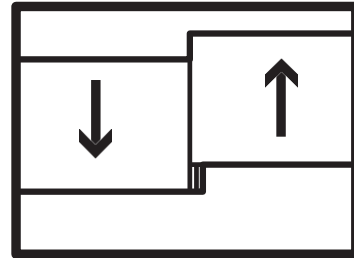

### IV. Cleaning & Maintenance

- Clean the floor regularly with a vacuum cleaner with soft bristle attachments or dry mop. If necessary, the floor may be cleaned with a wet mop and a non-abrasive laminate cleaner
- Avoid using too much liquid when cleaning your floor.
- The use of residential steam mops on this product is allowed. Use at lowest power with a suitable soft pad and do not hold the steam mop, for an extended period of time, in one location. Refer to the steam mop's manufacturer instructions for proper usage
- Promptly remove all liquid spills and never flood the floor with water.
- Do not use any cleaning agents containing wax, oil or polish. Left-over residue from these agents can leave a dull film on the floor and can damage it beyond repair.
- Do not use steel wool or scouring powder.
- Use either a natural or colorfast doormat outside and inside each entrance to your home to prevent dirt, sand, grit and other substances from being tracked onto the floor. Do not use mats with a rubber backing.
- Use wide-bearing, non-staining floor protectors, such as felt protectors for chair legs and table legs.